

Doors for **beverage, catering and scientific refrigerated appliances.**

## ALUMINUM FRAMED GLASS DOOR

A huge range of opportunities complying with any foaming thickness

RAL tinted frames are available on demand

Special aluminium surface treatments (Scotch brite, chrome...)

Any customized solution available on request

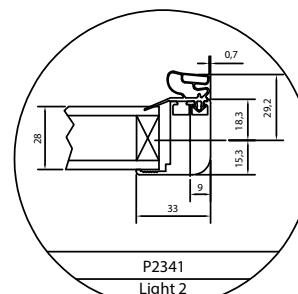
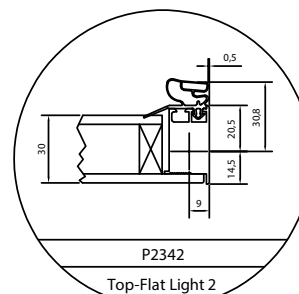
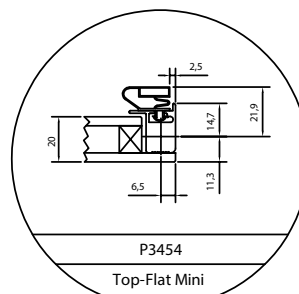
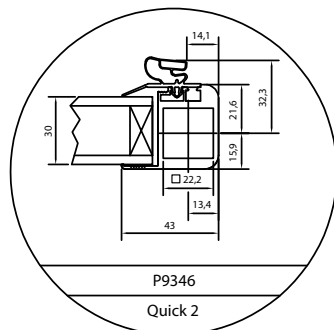
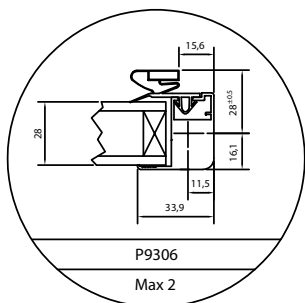
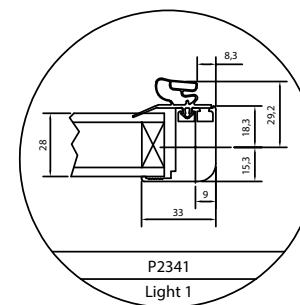
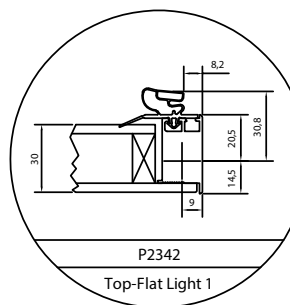
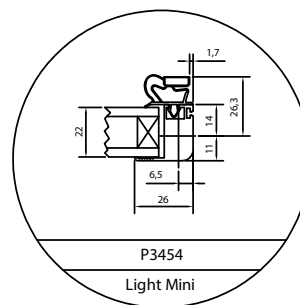
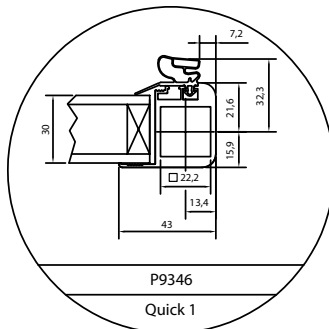
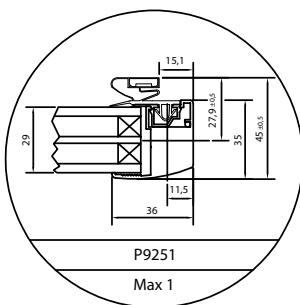
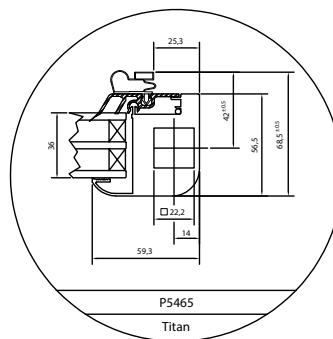
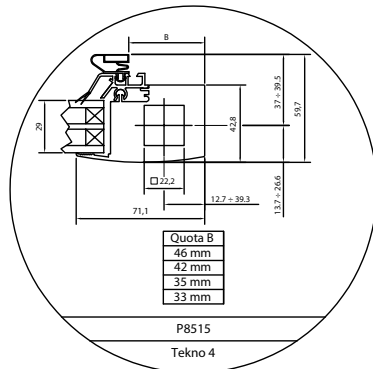
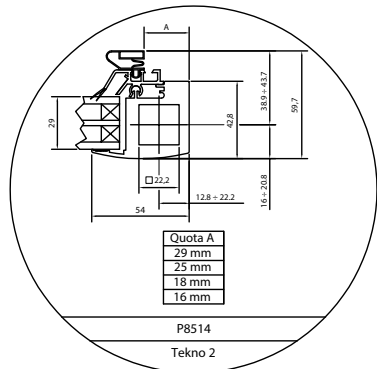



Doors for **beverage, catering and scientific refrigerated appliances.**

## NT doors:

Application temperatures range	from 5° C up to 30° C
Standard doors complying with	Class 3 UNI23953
Wide range of glass units available	from 24 to 35mm
Low-e glasses available on demand	from UG 1.9 down to 1.1
Coloured glasses available on demand	
UV ray filtering glasses available on demand	

## LT heating doors:

Application temperatures range	from -30° C up to 5° C
Standard doors complying with	Class 3 UNI23953
Wide range of glass units available	from 29 to 35mm
Low-e glasses available on demand	from UG 1.9 down to 1.1
Standard heating power 100W sqm on the glass and 7W lmt all along the door's profile	
Possibility to increase the heating power to comply with the worst operating conditions	
Possibility to tune the powering voltage on demand	

## LT 0 Energy doors:

Application temperatures range	-25° C up to 5° C
Standard doors complying with	Class 3 UNI23953
Wide range of glass units available	from 30 to 35mm
No electrical heating	
Wide range of Anti-Fog treatments on the inner side of the glass	

## AVAILABLE GLASS EMBEDDED SOLUTIONS:

Digital glass printing plotter to reproduce any tempering coloured serigraphy

### BLS1:

Patented solution for lighting refrigerated products by led included in the glass unit

### BLS2:

Patented Solution for lighting refrigerated products by led included in the glass door frame

### LAS:

Patented solution for lighting a customized logo embedded in the glass door by led

### Magic Vision:

upgrade transforming any glass door into a powerful means of communication which captures the attention of the consumer

**ALL DIMENSIONS AVAILABLE ON DEMAND**